

Orientierungshilfe Navigation Guide



© Foto Kraus

Inhaltsverzeichnis

Index

- 3** Standorte FH St. Pölten
[Locations St. Pölten UAS](#)
- 4** Sekretariate
[Administration](#)
Campus St. Pölten
- 5** A.0
- 6** A.1
- 7** A.2
- 8** A.3
- 9** Standorte D, E, F, G, H, I

Standorte FH St. Pölten

Locations St. Pölten UAS

A, B, C Campus St. Pölten Matthias Corvinus-Straße 15, 3100 St. Pölten

D BIZ Heinrich Schneidmadl-Straße 15, 3100 St. Pölten

E Herzogenburger Straße 66, 3100 St. Pölten

F, G Herzogenburger Straße 68, 3100 St. Pölten

H Herzogenburger Straße 69, 3100 St. Pölten

I Wiener Straße 12, 3100 St. Pölten



Sekretariate

A.2

A.2.23 Medien & Wirtschaft

- Medienmanagement (BA)
- Media Management (MA)
- Marketing & Kommunikation (BA)
- Digital Marketing & Kommunikation (MA)

A.2.38 Gesundheit

- Diätologie (BA)
- Physiotherapie (BA)
- Gesundheits- und Krankenpflege (BA)

A.3

A.3.36 Medien & Digitale Technologien

- Medientechnik (BA)
- Smart Engineering (BA)
- Digital Design (MA)
- Digital Media Production (MA)
- Interactive Technologies (MA)
- Digital Healthcare (MA)

A.3.25 Informatik & Security

- IT Security (BA)
- Data Science and Business Analytics (BA)
- Applied Research and Innovation in Computer Science (MA)
- Information Security (MA)

D.2

TOP 2.26/1 Bahntechnologie & Mobilität

- Bahntechnologie und Mobilität (BA)
- Bahntechnologie und Management von Bahnsystemen (MA)

F.2

Soziales

- F.2.06 Soziale Arbeit (BA)
- F.2.05 Soziale Arbeit (MA)

Administration

A.2

A.2.23 Media and Economics

- Media Management (BA)
- Media Management (MA)
- Marketing & Communication (BA)
- Digital Marketing & Communication (MA)

A.2.38 Health Sciences

- Dietetics (BA)
- Physiotherapy (BA)
- Healthcare and Nursing (BA)

A.3

A.3.36 Media and Digital Technologies

- Media Technology (BA)
- Smart Engineering (BA)
- Digital Design (MA)
- Digital Media Production (MA)
- Interactive Technologies (MA)
- Digital Healthcare (MA)

A.3.25 Computer Science and Security

- IT Security (BA)
- Data Science and Business Analytics (BA)
- Applied Research and Innovation in Computer Science (MA)
- Information Security (MA)

D.2

TOP 2.26/1 Rail Technology and Mobility

- Rail Technology and Mobility (BA)
- Rail Technology and Management of Railway Systems (MA)

F.2

Social Sciences

- F.2.06 Social Work (BA)
- F.2.05 Social Work (MA)

A.0

Campus & Study Center (CSC)

Mo–Do 07:30–16:30 Uhr
Fr 07:30–16:00 Uhr
Sa 07:30–12:00 Uhr

Bibliothek

Mo–Fr 09:00–19:30 Uhr
Sa 08:00–12:00 Uhr

Mensa

Mo–Fr 08:00–17:00 Uhr
Sa 11:30–13:30 Uhr

Campus & Study Center (CSC)

Mon–Thu 7:30 am–4:30 pm
Fri 7:30 am–4 pm
Sat 7:30–12:00 am

Library

Mon–Fri 9am–7:30 pm
Sat 8–12:00 am

Canteen

Mon–Fri 8am–5 pm
Sat 11:30 am–1:30 pm



A.1

- **A.1.37**
Campus Medien
On-campus Media
- **A.1.04–A.1.06**
EDV-Räume 1–3
Computer Rooms 1–3
- **A.1.02, A.1.03, A.1.12**
Physiotherapie 1–3
Physiotherapy 1–3
- **A.1.07–A.1.12, A.1.14, A.1.15, Sem. Siemens A.1.16** Seminarräume
Seminar Rooms
- **A.1.01**
Usability Lab/raiLAB
Usability Lab/raiLAB
- **A.1.17, A.1.18, A.1.26**
Finanzwesen und Controlling
Finance and Controlling
- **A.1.34–A.1.36**
Geschäftsführung
Executive Directors
- **A.1.21, A.1.23, A.1.25, A.1.28, A.1.30**
IT und Infrastruktur
IT and Infrastructure
- **A.1.13, A.1.19, A.1.20, A.1.22, A.1.24**
Marketing und Unternehmenskommunikation
Marketing and Communications
- **A.1.32, A.1.39**
Personal und Recht
Human Resources and Legal Affairs

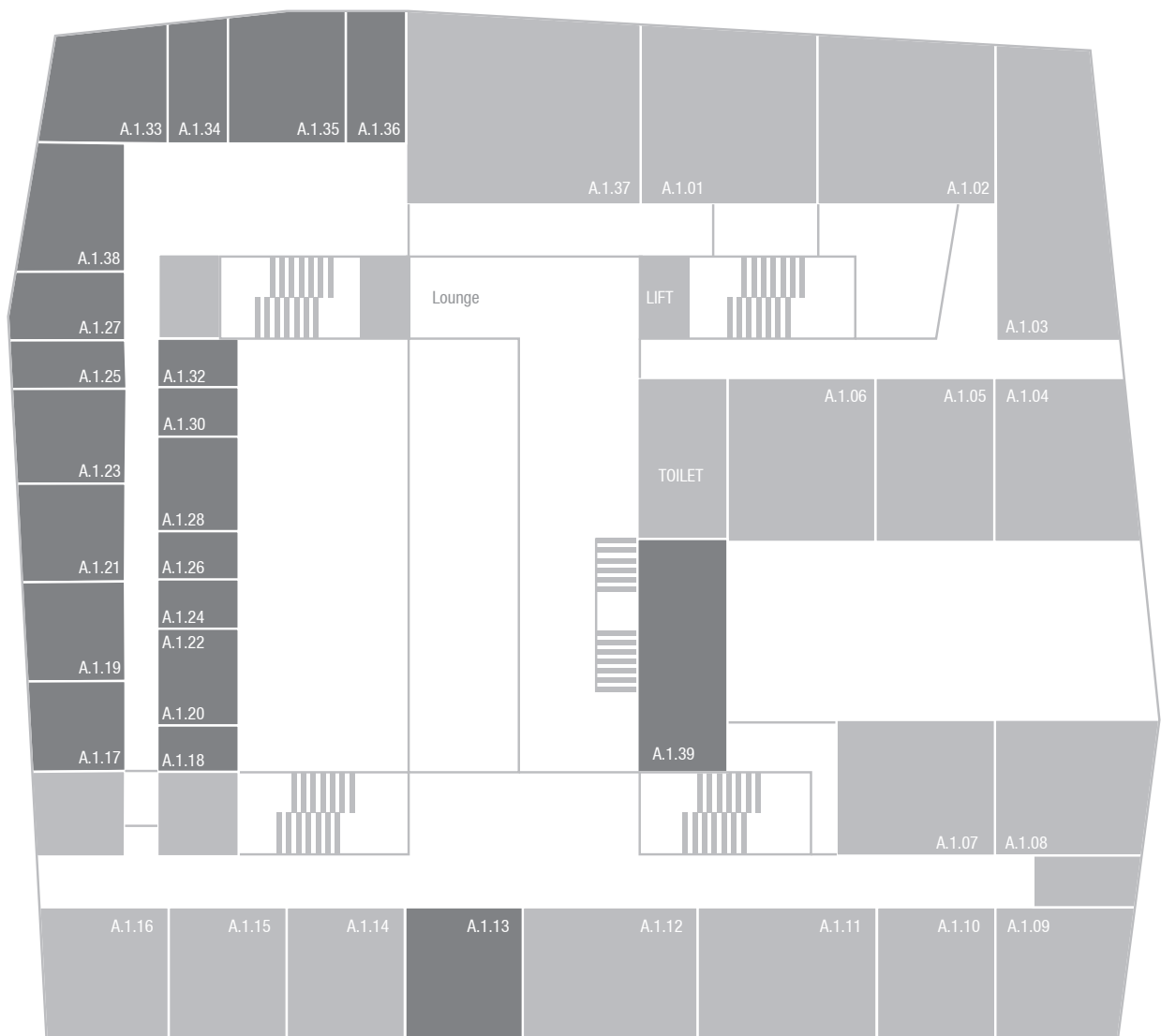

A.2

- **A.2.14, A.2.15**
Health Lab
- **A.2.01**
Interaktive Medien
[Interactive Media](#)
- **A.2.05**
Multimedia-Labor
[Multimedia Lab](#)
- **A.2.02–A.2.04, A.2.06**
Netzwerktechnik-Labor 1–4
[Network Technology Lab 1–4](#)
- **A.2.07–A.2.12**
Seminarräume
[Seminar Rooms](#)
- **A.2.40**
Alumni & Career Center
- **A.2.41**
ÖH
[Austrian Students' Union](#)
- **A.2.38**
Sekretariat /gesundheit
[Administration /health sciences](#)
- **A.1.13, A.1.19, A.1.20, A.1.22, A.1.24**
Marketing und Unternehmenskommunikation
[Marketing and Communications](#)
- **A.2.23**
Sekretariat /medien & wirtschaft
[Administration /media & economics](#)



A.3

- **A.3.02**
Audio-Labor A–C
Audio Lab A–C
- **A.3.01**
Elektronik-Labor/Industrie 4.0
Electronics Lab/Industry 4.0
- **A.3.04**
Medientechnik-Service-Center
Media Technology Service Centre
- **A.3.06**
PostPro-Studio
- **A.3.05**
TV-Studio
TV Studio
- **A.3.07–A.3.14**
Seminarräume
Seminar Rooms
- **A.3.15, A.3.16**
International Relations
Office for International Relations
- **A.3.25**
Sekretariat /informatik & security
Administration /computer science & security
- **A.3.36**
Sekretariat /medien & digitale technologien
Administration /media & digital technologies

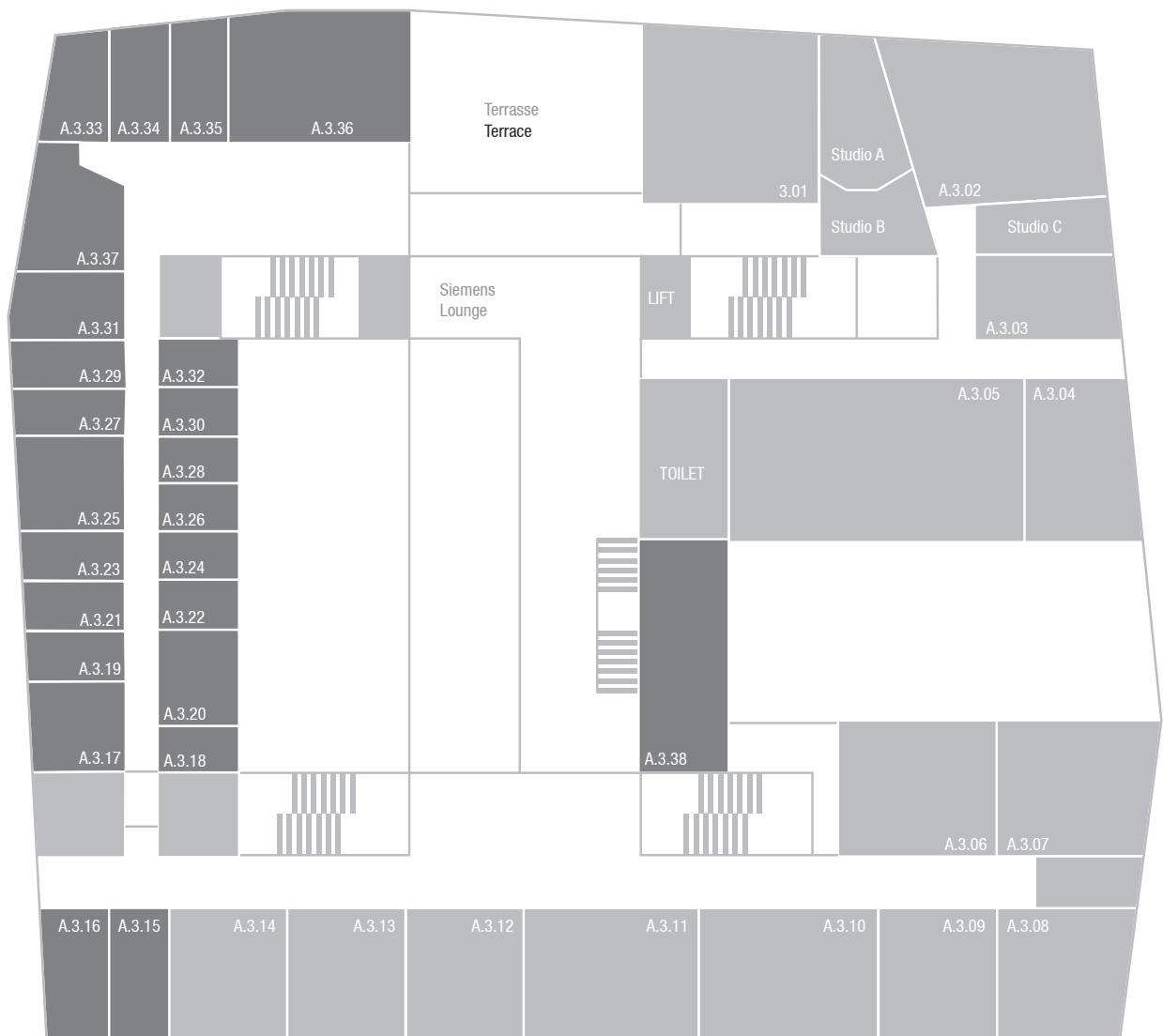

D

TOP 2.25

- Digital Health Lab

TOP 2.26/1 Bahntechnologie & Mobilität

- Bahntechnologie und Mobilität (BA)
[Rail Technology and Mobility \(BA\)](#)
- Bahntechnologie und Management von Bahnsystemen (MA)
[Rail Technology and Management of Railway Systems \(MA\)](#)

F

- Eltern-Kind-Raum
[Parent-Child Room](#)
- **F.1.05**
Kreativlab
[Creative Lab](#)
- **F.1.01, F.1.02**
Seminarräume
[Seminar Rooms](#)
- **F.2.05**
Sekretariat Soziale Arbeit (MA)
[Administration Social Work \(MA\)](#)
- **F.2.06**
Sekretariat Soziale Arbeit (BA)
[Administration Social Work \(BA\)](#)

H

- **H.1.11, H.1.12**
Seminarräume
[Seminar Rooms](#)

E

- E.0.01

G

- **G.0.03–G.0.05**
Seminarräume
[Seminar Rooms](#)
- **G.1.03–G.1.05**
Seminarräume
[Seminar Rooms](#)
- **G.2.03, G.2.04**
Seminarräume
[Seminar Rooms](#)

I

- **H.1.11, H.1.12**
Seminarräume
[Seminar Rooms](#)

